

W. M. Hales, Inc.

P. O. Box 26628 Greenville,
South Carolina 29616

864.268-6969
864.244.8253 (FAX) |
864.901.8000 (Mobile) |
www.skiphales.com
skip@skiphales.com

W. M. "Skip" Hales
Broker-in-Charge - License 181968770
Certified Appraiser - License CR 297
Certified Consultant - License 1908
Licensed Auctioneer - SCAL 3462

AMERICAN FAST PRINT ACREAGE FOR SALE

Parcel #3	29.0	\$ 339,500
Parcels #4 & 4A	96.54 + 19.0	\$1,100,000
Parcel #5 (Plant)	27.91 + 5.0 +	\$ 210,000
Parcel #8	37.19	74,900
Parcel #10	11.89	54,900

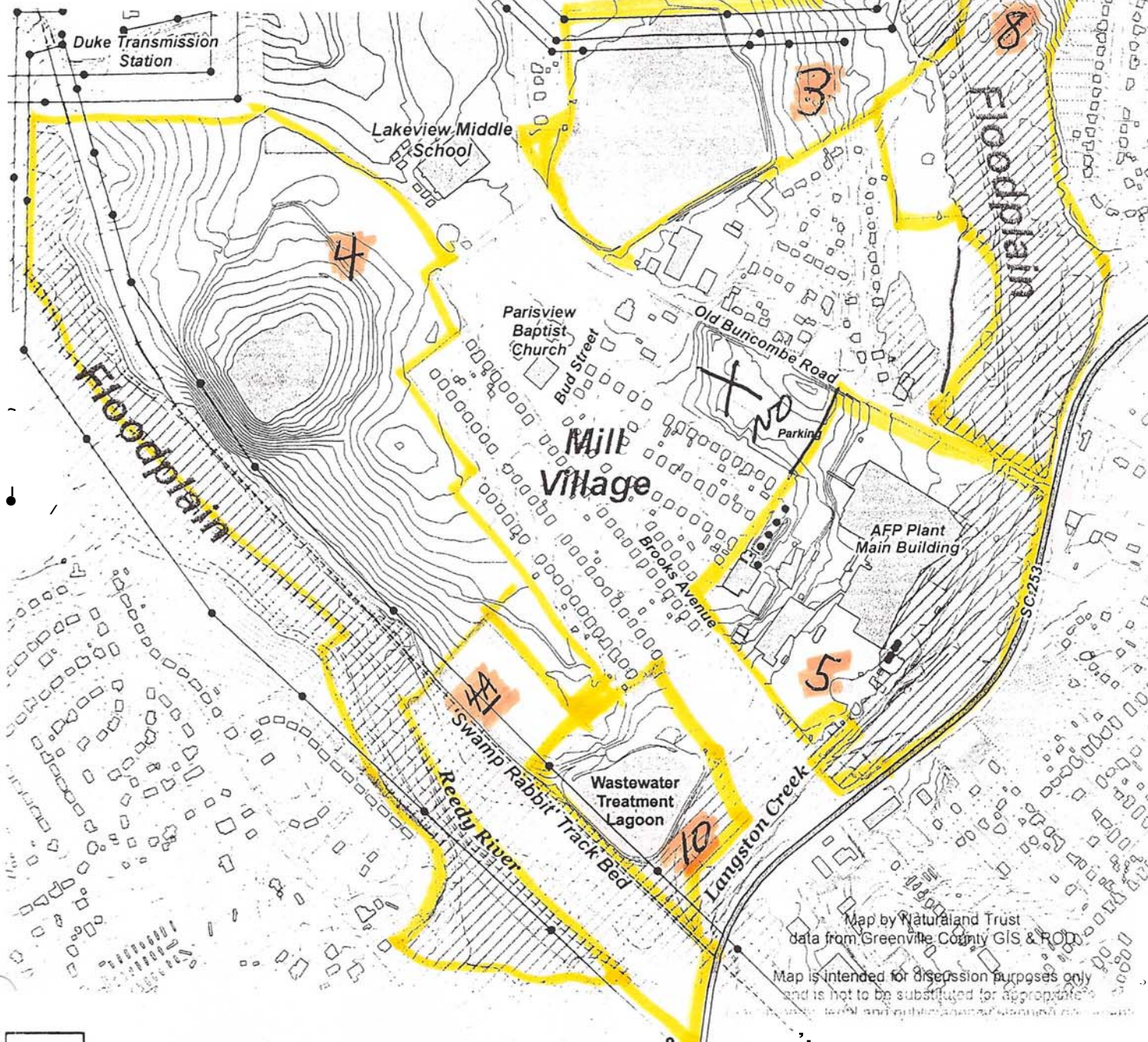

Map by Naturaland Trust
data from Greenville County GIS & ROD
Map is intended for discussion purposes only
and is not to be substituted for appropriate
survey, title and other legal documents.



map by NATURLAND TRUST* 0 375 750 1,500 2,250 3,000 Feet